

Ref. 500009

TECHNICAL DATA SHEET



BIPOLAR BATTERY MASTER SWITCH 24 VDC / 250 A



MAY 2005

• GENERAL CHARACTERISTICS:

Protection degree: IP 66
Ambient temperature: -40°C / +85°C
Weight: 1,00 Kg approx.
Contacts: Copper
Connections: not polarized

• PARTICULAR CHARACTERISTICS:

Removable handle with PVC protector

• FIELDS OF APPLICATION:

Agriculture machinery, industry...

• POWER CIRCUIT:

Connection: M10 terminals
Tightening torque: 1.5 +/-0.1 daN.m
Type: Normally Opened **BIPOLAR**
Max. using tension: 48 VDC
Capacity: 250 A in continuous
2500 A during 5 secs.

• SPARE PARTS:

Handle, chain and protection	520020
Handle	520029
Strap and PVC protection	520003

Electromecánica CORMAR

P.I. El Raiguer, C/ El Raiguer, s/n, nave nº26
08170 MONTORNÉS DEL VALLÈS
BARCELONA (SPAIN)
Tel. : + 34.93.544.44.80
Fax : + 34.93.544.44.90

SIZE DIAGRAM

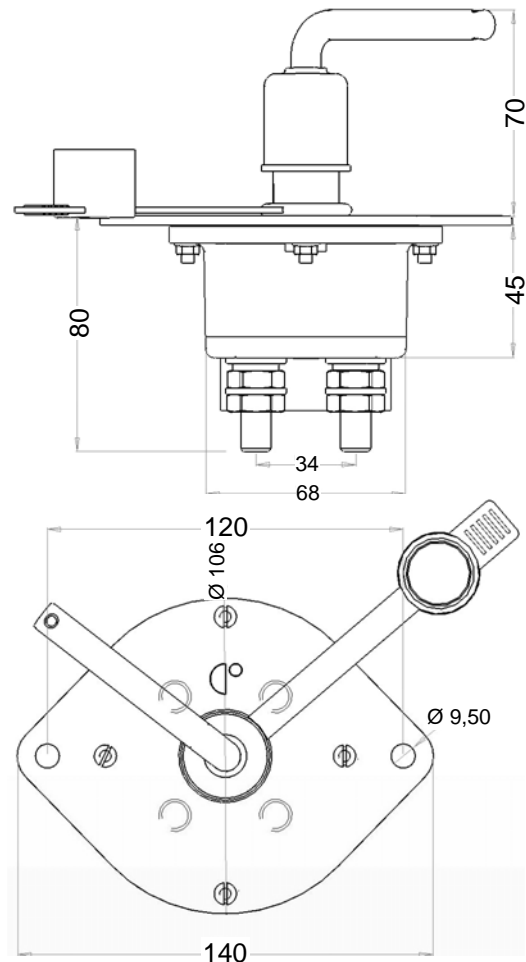

CONNECTION DIAGRAM

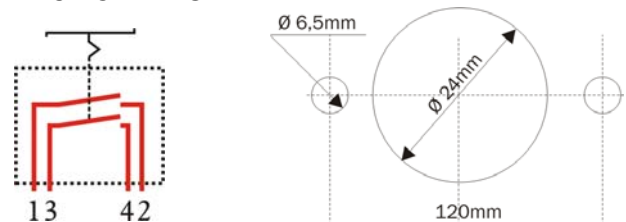

The assignment and the recommendation of the products inserted in our instructions take account of the state of vehicle stock at the day of their publication.
The manufacturer responsibility could not be engaged in case of modification, substitution or suppression of assignments or recommendations which could be occur without advance warning particularly by vehicle manufacturer initiative.
The technical characteristics of our products are liable to advance at every time to take account of the technical and technological improvements.
No contractual document.